

CTS REAR ENGINE

The Greatest Price Value
in the Industry!



CTS Rear Engine Key Features & Benefits

- Rear engine power and stability with a tight turning radius and 96" or 102" overall width
- With lengths from 30' to 38', CTS rear engine can seat up to 45 passengers
- Built with Champion's exclusive "Steelgard" all-steel inner cage structure for superior durability
- Available in Freightliner XB-55 and XB-75 rear engine chassis
- GVWR ranges from 26,500 lbs. to 31,000 lbs.

When you want to move lots of people in and out of virtually anywhere, CTS Rear Engine is just the right bus for the job!



THOR
AMERICA'S BEST BUS INVESTMENT

Call (800) 331-5761
www.championbus.com
sales@championbus.com



**CTS Rear Engine
Standard Features**

Chassis

- Rear mounted engine
- Automatic transmission
- XB-55 Allison 2000
- XB-75 Allison B300
- 270 amp alternator
- Dual batteries-slide tray
- Tilt steering wheel
- ABS air brakes
- Power steering
- 4.63 rear axle ratio - XB-55
- 5.13 rear axle ratio - XB-75
- Air-ride suspension
- 255/80R 22.5 radial tires XB-55
- 275/80R 22.5 radial tires XB-75

Conversion Features

- Steelgard cage structure
- Rust inhibitor
- Electric passenger entry door
- 12V electrical panel
- Exterior painted white
- Fiberglass front cap
- Galvanized steel exterior
- Foamed insulation
- Carpet floor w/rubber aisle
- Passenger door entry light
- Side view mirrors
- Modesty panel at entry door
- Rub rail-rubber
- Steel wheelwells
- Windows - tinted T-slider top
- Track seating
- Rear mud flaps

Options

A variety of heating, cooling, electrical, seating and other options are available

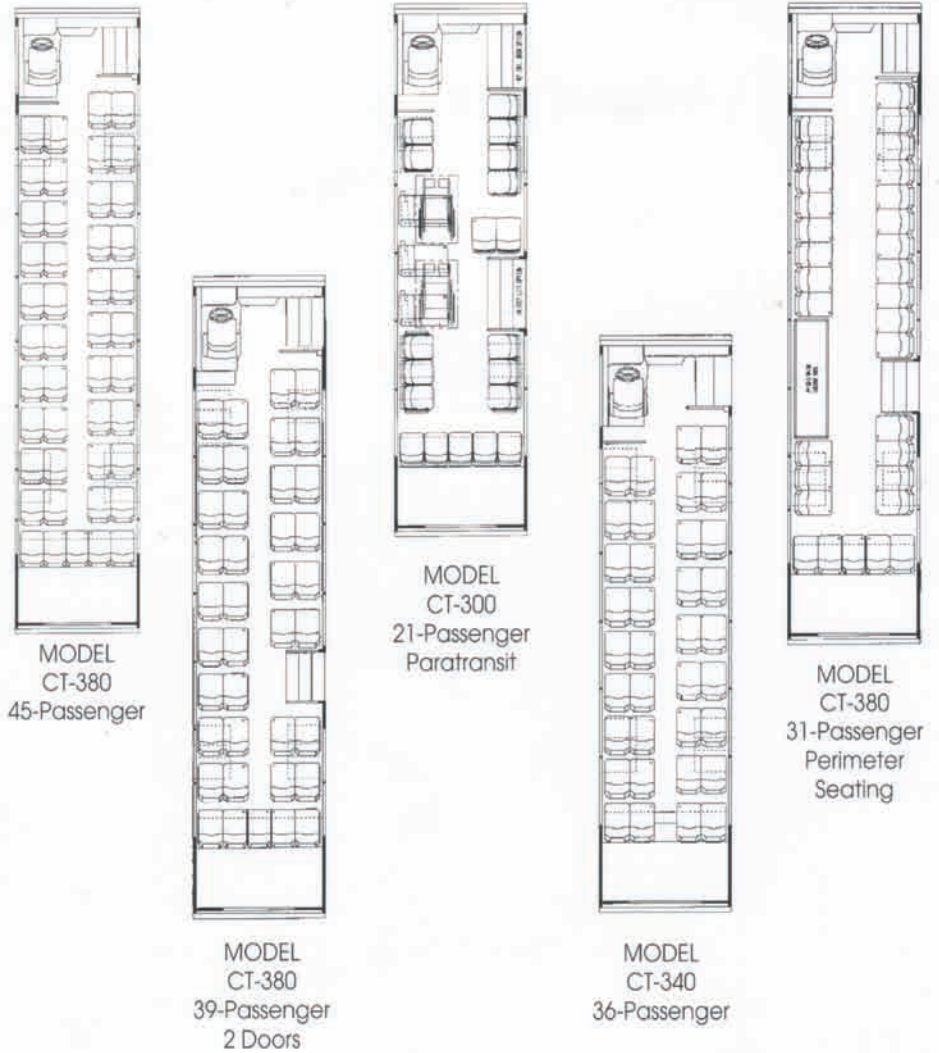

CTS Rear Engine Specifications	
Chasis	Freightliner XB-55/75
Engine	Cummins ISB 205/245 HP
Fuel Tank Cap.	60 & 90 gal.
Alternate fuel	Future
Wheelbase	160", 236", 252"
GVWR	26,500 & 31,000 lbs.
Lengths*	30', 35', 38'
Exterior Height**	122"
Exterior Width	102"
Interior Height	78"
Interior Width	96.5"

* Lengths measured with std. bumper

** Add 4.5" for roof vent. Add 12" for front sign. Add 9.75" for roof air.

NOTE: Champion Bus Inc. reserves the right to make changes at any time in prices, colors, materials, equipment, design specification and models, and also to discontinue models without notice and/or obligations. Data shown is basic information for the prospective buyer effective at the time of issuance of this literature. Dealer will provide complete up-to-date information on available equipment specifications, etc., not shown here. Items referred to as "options" or are "available" are at extra cost.



A Quality GM Chassis Converter

email: sales@championbus.com



**CHAMPION
BUS, INC.**

Thor Industries Commercial Bus Division

331 Graham Road • P.O. Box 158 • Imlay City, MI 48444
(810) 724-6474 or (800) 331-5761 • Fax (810) 724-1844
www.championbus.com